

# STAINLESS STEEL 304 PRESS FIT FITTINGS (M PROFILE)

COMPLY WITH BSEN1254-2: 1998  
AS 3688: 2005  
AS/NZS 4020: 2005  
SS 375: 2015  
SS 270: 2015

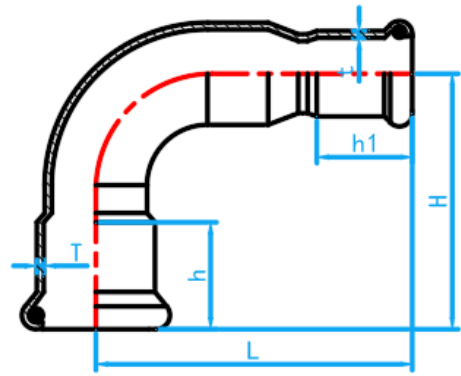

## REDUCER 90° ELBOW



CROSS SECTIONAL VIEW

### DIMENSIONS

SKU	SIZE (mm)	H (mm)	L (mm)	h (mm)	h1 (mm)	T (mm)	t (mm)	WEIGHT (kg)	PCS/CTN
SSPFNRE9002015	22x15	48.5	41	21	20	1.5	1.5	0.064	160
SSPFNRE9002515	28x15	56.0	41	23	20	1.5	1.5	0.078	140
SSPFNRE9002520	28x22	55.0	48.5	23	21	1.5	1.5	0.094	160
SSPFNRE9003515	35x15	61.5	43.0	26	20	1.5	1.5	0.095	100
SSPFNRE9003520	35x22	64.0	48.0	26	21	1.5	1.5	0.113	80
SSPFNRE9003525	35x28	67.0	58.0	26	23	1.5	1.5	0.133	90
SSPFNRE9004215	42x15	66.5	40.0	31	20	1.5	1.5	0.123	60
SSPFNRE9004220	42x22	73.0	48.0	31	21	1.5	1.5	0.142	60
SSPFNRE9004225	42x28	78.5	60.0	31	23	1.5	1.5	0.163	60
SSPFNRE9005015	54x15	83.5	42.5	36	20	1.5	1.5	0.205	56
SSPFNRE9005020	54x22	88.0	48.0	36	21	1.5	1.5	0.186	-
SSPFNRE9005025	54x28	89.0	61.0	36	23	1.5	1.5	0.215	56
SSPFNRE9005035	54x35	96.0	72.0	36	26	1.5	1.5	0.265	30
SSPFNRE9005042	54x42	104.5	85.0	36	31	1.5	1.5	0.298	30
SSPFNRE9006525	67x28	115.0	60.5	50	23	2.0	1.5	0.354	15
SSPFNRE9006535	67x35	132.0	73.0	50	26	2.0	1.5	0.394	15
SSPFNRE9006542	67x42	127.5	85.0	50	31	2.0	1.5	0.428	-
SSPFNRE9006550	67x54	142.5	105.0	50	36	2.0	1.5	0.523	-